

LASER SIGHTS: AN EFFECTIVE NEW TRAINING TOOL

Incorporating Crimson Trace Lasergrips into firearms training for beginning to advanced students

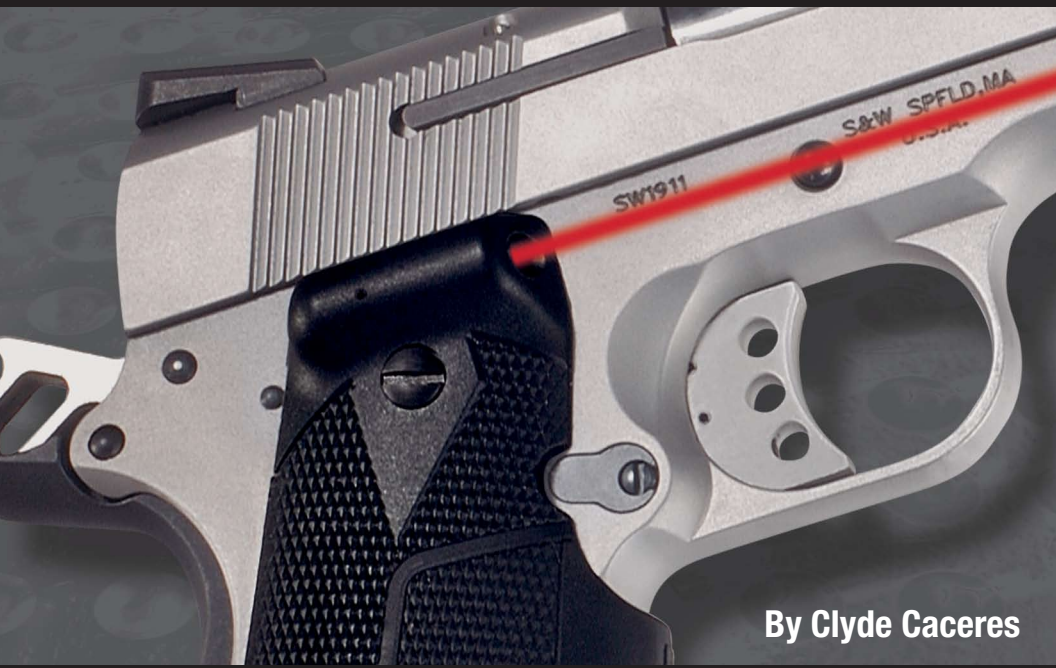

By Clyde Caceres

Crimson  **Trace**

L A S E R G R I P S®

I. THE BEST INSTRUCTORS NEVER STOP LEARNING

It's a fact that the best trainers continually strive to improve their teaching techniques and utilize the latest tools and approaches to increase their students' shooting proficiency.

Firearms instructors are finding that Lasergrips are an extremely useful and under-utilized tool for handgun training. Lasergrips offer unique advantages for trainers and students that can help achieve superior training results much faster and more effectively than any other tool.

"Lasergrips have proven to be an essential tool for professional firearms training. I've been using them for years because of their ability to quickly identify and correct improper shooting techniques. The results with students speak for themselves."

KEN HACKATHORN, INTERNATIONAL SMALL ARMS INSTRUCTOR & CONSULTANT

II. TRAINING BASICS USING LASERGRIPS

Shooting, like many other disciplines, is best learned as a process. By embedding proper physical skills through repetition and hands-on practice, your students will become better at the process. Lasergrips support this learning by providing **immediate visual feedback** on how well the student is executing a given technique.

The conflict is this: learning the process is the ultimate goal, but bullet placement on the target is how the student is evaluated. It's easy to focus on the result, holes in the target, instead of the process that created them. Furthermore, these holes are often created under the stressful environment of the firing range, where students experience doubt, peer pressure and anxiety.

How does training with a laser help? Unlike simply observing the student and looking at holes in a target to evaluate skill, **the laser vividly illustrates the complete picture of gun handling and technique from start to finish**. Think of the laser as showing the coach and student a movie with all of the details filled in (process), rather than just a snapshot (result... holes in the target). The most important habits and behaviors of the shooter, from safety and presenting the firearm, through shooting and following through after firing a round, are visible, recordable and available as a teaching tool. Use the laser with an empty gun to diagnose bad habits and impart new, correct ones.

Probably the most significant training assistance Lasergrips provide is diagnosing and correcting two critical skills: **trigger control** and **sight picture**. If you come away with one thing, it's that Lasergrips will positively become your go-to tactic for diagnosing and correcting trigger control and sight picture techniques. There's simply no better tool available.

III. TRIGGER CONTROL

Without question, one of the most critical techniques in achieving consistent shooting results is proper trigger control. Although trainers continue to repeat the words, "smooth, steady trigger press" over and over, students often are confused about what is happening with their trigger pull and why they may not be correcting poor technique. Lasergrips are hands-down the fastest and most effective tool for diagnosing and correcting trigger control issues.

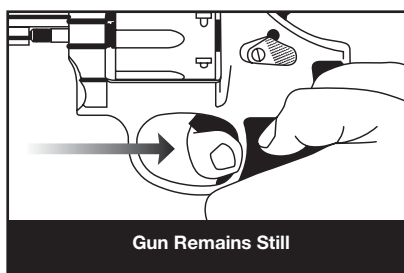
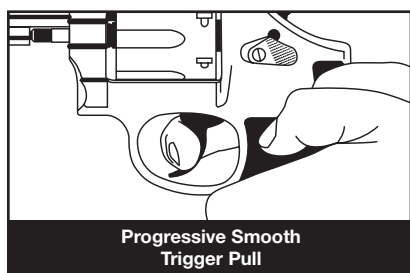

The obvious advantage of using Lasergrips is that they put a visible dot on the target that clearly shows students and trainers the impact of every improper movement during the shooting process. It shows students their errors in real time and allows them to self-correct.

Dry firing while holding the dot on the target is a very effective technique. Once students have demonstrated that they can perform dry fire drills with the laser staying steady, they are ready for live fire. Firing with the laser, then firing with the laser off, will immediately demonstrate whether a student has retained proper trigger control technique. If the student regresses, unloading the gun and going through further dry fire sessions and trigger control drills will reinforce the right habits.

"I use a Lasergrip-equipped gun to demonstrate proper trigger control. The laser dot provides instant feedback on gun movement before and during trigger squeeze. In my last class a student improved her groups from 24" to 4" after only a dozen dry practice cycles (less than 6 minutes)."

LEE ANDERSON, FIREARMS TRAINING TEAM, PORTLAND, OREGON

IV. SIGHT ALIGNMENT

After trigger control, sight alignment is probably the next most important skill needed for good shooting results. Yes, the laser itself can be used as a sighting tool. **Lasergrips are also extremely effective for teaching traditional sight alignment because they clearly show exactly where the student is aiming.**

Often, you'll see trainers stand behind a student and try to look "through" a student's head to see what their sight alignment (picture) looks like. How many times have you done it? Unfortunately, it is impossible for more than one person to look down the sights of a pistol at the same time. Lasergrips help by demonstrating exactly where the bullet will strike the target, without taking a shot.

Here's how: First, the instructor needs to make sure the Lasergrips dot and the traditional sights are aligned at shooting distance (5 – 7 yards). Next, confirm your student understands proper sight picture by reviewing all the charts, pictures, models and diagrams that you have depicting proper sight picture.

Now it gets easy. With the laser activated, ask the student to aim through their traditional sights at a target while you block the laser beam with your finger. When your student confirms that they have "perfect" sight picture and alignment on the target, ask them to hold that position. Now move your finger. If their sight picture was perfect, the dot will hit the center of the target. If the dot is anywhere else, then they obviously need to realign their sight picture. Students also can perform the exercise by blocking and unblocking the laser with their own trigger finger. Usually, trying again several times until the dot and target align consistently is all it takes to confirm proper sight picture in their mind's eye. If the dot is repeatedly off the target center, go to the next step.

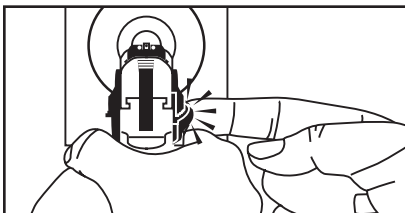

**Cover Laser
and Confirm Sight Picture**

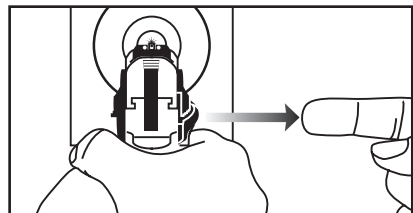

**Uncover Laser
to See Student's Sight Picture**

Now you're going to reverse the process. Have the student aim their gun at the target. This time they are going to "lock" the laser on the target and look slightly over the traditional sights. The student holds the dot on the target and keeps it there. Then the student slowly lowers their eyes to the traditional sight picture, maintaining sight picture and laser dot in the same place. If the student has a poor understanding of sight picture, they will force the dot into a different location as they revert to their "mind's eye" view of sight picture. Once the student maintains "proper" sight picture while keeping the dot on target, they usually have it.

Developing accurate sight picture is often very frustrating to both trainers and students. **Lasergrips provide an effective, visible training tool that can dramatically reduce teaching time and improve results.**

"Because you can't see what the student sees, sight picture is one of those skills that's difficult to teach and even more difficult to diagnose and correct. I can't think of a better tool than Lasergrips to help students understand and develop consistent sight picture techniques."

WES DOSS, 21 YEARS IN LAW ENFORCEMENT/MILITARY, AUTHOR,
LEAD NRA LAW ENFORCEMENT FIREARMS INSTRUCTOR

V. SAFETY FIRST

- 1. ALWAYS keep the gun pointed in a safe direction.***
- 2. ALWAYS keep your finger off the trigger until ready to shoot.***
- 3. ALWAYS keep the gun unloaded until ready to use.***

Safety is the overriding concern at all times. Always keeping the gun pointed in a safe direction is a MUST. Using Lasergrips, the bright red dot emanating from a student's gun lets an instructor know where each student's muzzle is pointed from any location on a range. No more need to say, "Imagine you have a laser emanating from the muzzle of your gun." Now you have a "real" visual tool to reveal unsafe muzzle control. You have all witnessed the horror of someone unexpectedly turning with their gun, drawing and presenting with the muzzle sweeping their hands, sweeping their hand while re-holstering, clearing a malfunction or unloading with the muzzle flying in all directions. **Lasergrips draw clear attention to where every muzzle is pointed at all times. Lasergrips provide indisputable evidence of safe or unsafe muzzle direction, making your job easier and your students safer.**

VI. BEYOND THE BASICS

This section covers defensive training. It may not fall within the scope of your credentials, abilities and the NRA program you teach. Use it as appropriate.

Once a student is skilled and competent in basic firearms use and safety, instructors can move into more advance training and scenarios such as marksmanship or defensive tactics. Lasergrips can easily be incorporated into advanced shooting drills and scenarios to demonstrate the laser's unique advantages as a tactical firearms enhancement.

Trainers know that developing consistent shooting results involves imparting an instinctive "muscle memory" that develops through repetition of sound shooting techniques. Using Lasergrips in training accelerates the development of muscle memory by visually correlating the "feel" of the firearm's position with the actual point-of-aim. No other training tool can do this. Once established, muscle memory transitions easily to training with traditional sights or with the laser turned off.

TRAINING TO SHOOT WHEN YOU CAN'T SEE YOUR SIGHTS

Lasergrips provide very effective sighting compensation when a student can't see his sights due to darkness and low-light conditions, physical obstructions, eye contaminants (irritants, tears, blood), or loss of corrective lenses. The bright red dot will accurately show the point of aim and point of impact, regardless of whether the student is able to visually align his sights on the target.

TRAINING TO SHOOT FROM AWKWARD POSITIONS

Accurately sighting a handgun while lying prone or from behind cover can be very difficult, even for highly trained shooters. The eyes and the gun sights just don't align very well when the shooter isn't standing up. Lasergrips overcome this challenge, and are the best tool ever developed for maintaining accurate sighting from awkward positions.

How do Lasergrips help? Whether with a Lasergrip-equipped blue training gun, or a positively inoperable training gun, Lasergrips give your students an opportunity to practice orienting their guns toward targets from any conceivable position. The translation to real life is simple. Lasergrips allow your students to have confidence that they can accurately sight their gun from the ground, behind a door jam or car door, or any other real-life cover position.

A police officer I know summed it up when he said: “I’ve been in two shootings. I’ve been shot in both of them and I returned fire in both of them. In neither one was I standing up... I don’t even know why we bother to train standing up!”

Though his experience might be more than most of your students would ever encounter, the lesson still applies. Shooting from a standing platform, squared to the target, is the furthest thing from the reality of most personal defense shooting scenarios.

SHOOTING WHILE MOVING

Another real-life shooting scenario that’s very different from the range involves shooting while the shooter and target are moving. If a student ever has to shoot in a real-life situation, it’s very likely that they’ll be moving. It’s also very likely that the “bad guy” will be moving, too. This reality once again shows the absolute power of Lasergrips as a defensive training tool for moving-target situations and moving-shooter situations.

Lasergrips on a blue training gun allows your students to practice keeping their muzzle on target while walking, running or crawling. In fact, trainers for years have recommended moving when faced with a threat to create distance and force the opponent to aim at a moving target. Lasergrips are very helpful in this scenario, and as a training tool to enhance the learning process.

VI. LASERGRIPS: A DESIGN SO UNIQUE, IT’S PATENTED

By now you should have an understanding of just how effective Lasergrips can be as a training tool. Here is some background information about Lasergrips technology:

Crimson Trace Lasergrips utilize patented technology that builds a high-intensity laser, pressure-activation switch and batteries right into a comfortable, high-quality gun grip. The technology was invented by avid shooters who saw the need for a simple, durable and easy-to-operate laser sighting system.

The product is precision engineered to replace the original factory stocks. Installation in nearly all models involves simply placing the batteries in the unit and then replacing the original factory grip using the same hardware.

Lasergrips are different from any other laser sighting system, and offer many advantages over rail-mounted, internally-mounted, or laser/tactical light units. Nothing is hanging off the gun awkwardly, or is

mounted internally among critical operating parts. Some laser systems need to be switched on in a separate hand action, but Crimson Trace Lasergrips feature instinctive activation. A built-in pressure sensitive switch activates the laser simply by grasping the firearm in a firm, shooting grip. When grip tension eases, or the situation dictates that the laser should be turned off, a simple relaxation of the hand or finger on the grip disengages the pressure switch and turns off the beam. A master switch turns off the laser system, returning it to “iron sights only” mode. Inexpensive batteries last for hours of constant use, and are readily available. Lasergrips are compatible with nearly all standard gun holsters. Another important feature is that Lasergrips can easily be adjusted for elevation and windage should the need arise. Fixed-aim units can’t be adjusted, or must be sent to the factory and adjusted with the gun.

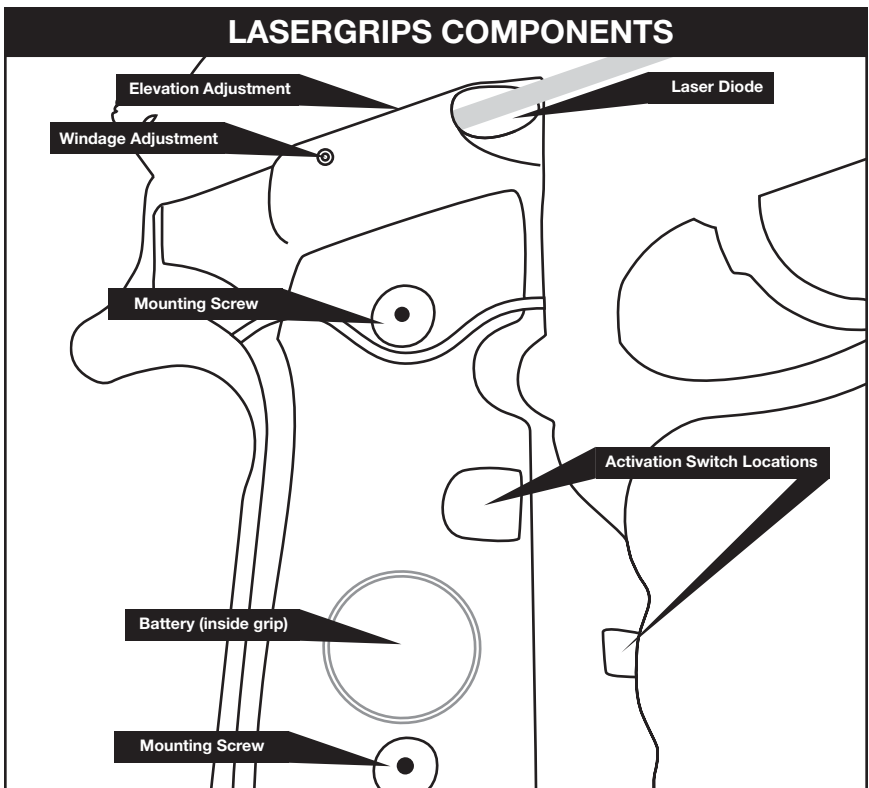

Key Features:

- The world’s only grip-integrated laser system.
- Instinctive activation. Pressure activated switch turns on laser when gun is held in a firm, normal grip.
- Adjustable for windage and elevation.
- Does not replace or alter critical internal components.
- High-visibility laser diode.
- 3-year warranty.

VII. TRAINING AIDS

Crimson Trace Lasergrips mounted on blue guns are available as training aids. They allow you to demonstrate handgun basics, tactics, and scenarios in a non-threatening and safe manner in the classroom, with the added benefit of the visible laser sighting system illuminating specific training points.

“Lasergrips have been a part of my classes for a long time. I now have 7 real handguns equipped with Lasergrips that I use in classes. People new to firearms & self-defense training are reluctant to pick up and handle the real firearms, but these same people have no problem when it comes to handling the Lasergrip-equipped blue gun.”

DONALD “JIM” JACOBE, FIREARMS & SELF-DEFENSE TRAINING INSTRUCTOR



VIII. SPECIAL PURCHASE PROGRAM FOR NRA CERTIFIED INSTRUCTORS

Crimson Trace and the NRA have partnered to offer Lasergrips and training tools to NRA Certified Instructors at a significantly discounted price. In addition, Crimson Trace will donate \$20.00 to the NRA's Firearms and Marksmanship Training Endowment for each Lasergrip set purchased through this special program. Blue training guns, with or without Lasergrips, are also available for purchase.

Please contact Crimson Trace directly at 800-442-2406, via e-mail at trainer@crimsontrace.com, or on the web at www.crimsontrace.com/trainer.



NRATM

IX. Application Guide

SEMI-AUTO PISTOL LASERGRIPS

1911 GOVERNMENT AND COMMANDER

1911 and 1991A1 full-size frames, including: Auto-Ordnance, Les Baer, Colt, Kimber, Olympic Arms, Para-Ordnance (full-size, single-stack), Safari Arms, Sig Sauer, Smith & Wesson, Springfield Armory, Dan Wesson, Wilson, and most other 1911's with grip screws measuring 3-1/16" apart

LG-401 Rubber Overmold, Front Activation*

LG-301 Rubber Overmold*

1911 OFFICER'S, COMPACT AND DEFENDER

Colt (officer's and defender), Kimber (compact, ultra-carry and ultra-elite), Para-Ordnance (compact, single-stack), Springfield Armory (compact and ultra-compact) Wilson and most other 1911's with grip screws measuring 2-11/16" apart

LG-404 Rubber Overmold, Front Activation*

LG-304 Rubber Overmold*

BERETTA 92/96

LG-302 Rubber Overmold *Beretta 92 and 96 large frame, including the Centurion, Elite II and Brigadier*
NSN #5855-01-485-4098

BERETTA 92/96 VERTEC

LG-312 Rubber Overmold *Beretta 92/96 Vertec including Elite IA*

BROWNING HI-POWER

LG-309 Rubber Overmold

GLOCK

LG-617 *Glock 17, 17L, 20**, 21**, 22, 24, 31, 34, 35 and 37*

LG-619 *Glock 19, 23, 25, 32 and 38*

LG-626 *Glock 26, 27, 28, 33 and 39*

LG-629 *Glock 29 and 30*

RUGER MK II and III

LG-203 Hard Polymer *All steel-frame MK and KMK models*

NSN #5855-01-466-5212

RUGER P-SERIES

LG-389 Rubber Overmold *All metal-frame Ruger P-Series pistols, including P-85, 89, 90, 91, 94 and 944*

SIG SAUER P220

LG-320 Rubber Overmold

SIG SAUER P226

LG-326 Rubber Overmold

SIG SAUER P228/229

LG-329 Rubber Overmold

SIG SAUER

LG-438 Rubber Overmold *Sig pro, 2009, 2340 and 2022*

SIG SAUER 239

LG-439 Rubber Overmold

SMITH & WESSON 3RD GENERATION, FULL-SIZE, DOUBLE-STACK

Third Generation, large frame, full-size, double-stack, 9mm and .40 cal. autos, Models 410, 410S, 411, 910, 910S, 915, 4003, 4003TSW, 4006, 4006TSW, 4043, 4046, 5903, 5903TSW, 5906, 5906TSW, 5943 and 5946

LG-359 Rubber Overmold

REVOLVER LASERGRIPS

RUGER BLACKHAWK, SINGLE-SIX AND VAQUERO

LG-210 Hard Polymer *(will not fit Birdshead or Bisley style grips)*

RUGER SP-101

LG-101 Hard Polymer

SMITH & WESSON J-FRAME ROUND BUTT

Airlight, Airweight, Bodyguard, Chief's Special, Centennial, Ladysmith, Models 36, 37, 38, 49, 60, 63, 317, 331, 332, 337, 340, 342, 351, 360, 442, 637, 638, 640, 642, 649, 651 and 940

LG-405 Rubber Overmold

LG-305 Rubber Overmold

LG-205 Hard Polymer

SMITH & WESSON K AND L-FRAMES

Models 10 thru 19, 48, 53, 56, 64 thru 68, 242, 296, 386, 396, 547, 581, 586, 617, 647, 648, 686 and 696

LG-306 Rubber Overmold, Round Butt (Compact Grip)

LG-308 Rubber Overmold, Round Butt (HogHunter)

LG-307 Rubber Overmold, Square Butt (HogHunter)

SMITH & WESSON N-FRAMES

Models 20 thru 29, 57, 58, 325, 327, 329, 520, 610, 624, 625, 627, 629 and 657

LG-314 Rubber Overmold, Round Butt (HogHunter)

LG-313 Rubber Overmold, Square Butt (HogHunter)

SMITH & WESSON K, L AND N-FRAMES

Models 10 thru 29, 48, 53, 56, 57, 58, 64 thru 68, 242, 329, 396, 520, 547, 581, 586, 610, 617, 624, 625, 627, 629, 648, 657, 686 and 696

LG-207 Hard Polymer Square Butt*** *(fits round or square butt frames)*

TAURUS SMALL FRAME REVOLVERS

Models 85, 94, 605, 650 CIA, 651 CIA, 731, 850 CIA, 905 and 941

LG-085 Hard Polymer****

LONG-GUN LASERGRIPS

AR-15 / M-16

AR-15 / M-16, A1 and A2 only (will NOT fit rifles with removable carry-handle)

LG-525 Rubber Overmold

RAIL MOUNT

Vertical Foregrip for all Picatinny (1913) rails, twin thumbscrew mount

VF-302 Rubber Overmold

Vertical Foregrip for all Picatinny (1913) rails; Military style, quick detach A.R.M.S. mount

VF-302M Rubber Overmold

FIT NOTES

* If pistol has ambidextrous safety, right-hand lever must be shortened to clear laser. Pre-shortened Ed Brown safeties are available from CTC, but must be fitted by a gunsmith.

** 3rd Gen Glock 20 and 21 frames only (identifiable by finger grooves on grip)

*** Will not fit K-Frame Scandium revolvers.

**** Titanium frames have the lower frame pin shifted up about 0.020" from the steel frames. Slight trimming of the grip may be necessary to clear this pin. WILL NOT FIT FRAMES WITH "RIBBER" GRIPS.

Questions about fit on your gun? Call us at 1-800-442-2406 or go online to our forum at www.crimsontrace.com



ABOUT THE AUTHOR

Clyde Caceres of Crimson Trace Corporation is a nationally recognized law enforcement, military and civilian firearms training instructor. He is an expert in the use of lasers for training and tactical applications.

Crimson  Trace

8089 SW Cirrus Drive, Beaverton, OR 97008
Phone: (800) 442-2406 or (503) 627-9992

www.crimsontrace.com